

SINK PACKAGE

SPECIALTY PRODUCTS



features and benefits

- ADA compliant
- Package complete with gooseneck and bubbler
- Manufactured from 304 stainless steel
- 1 3/4" radius corners
- Non-porous interior and top surfaces
- USA lead requirements met, tapware made from stainless steel

about

BRITEX Stainless Sink Package, manufactured from heavy gauge grade 304 satin S.S., making it highly durable and easy to clean, incorporating a stainless steel gooseneck and bubble. The ADA-compliant fixture is ideal for all applications.

sample spec. text

BRITEX S.S. Sink Package - Product Code US-1988-ADA

*RED TEXT may denote a **variable** where one option only is to be selected, a **nominal dimension** that needs to be specified, or an **optional feature** that can be removed if not required. Please refer to the back of this page for additional specification details and options.

VISIT BRITEXUSA.COM TO DOWNLOAD THE MOST CURRENT PRODUCT LITERATURE.

#US-1988-ADA / SINK PACKAGE

SINK PACKAGE

PRODUCT CODE

US-1988-ADA

SPECIALTY PRODUCTS

#US-1988-ADA / SINK PACKAGE

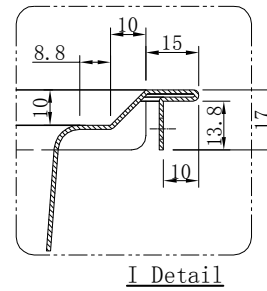
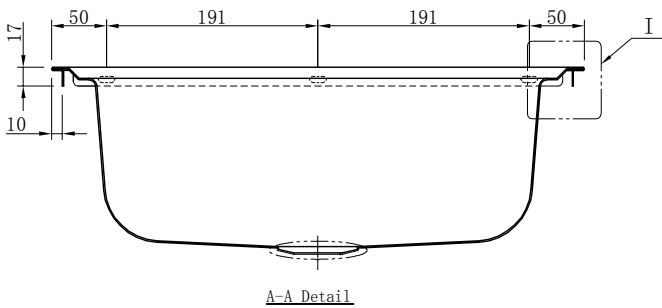
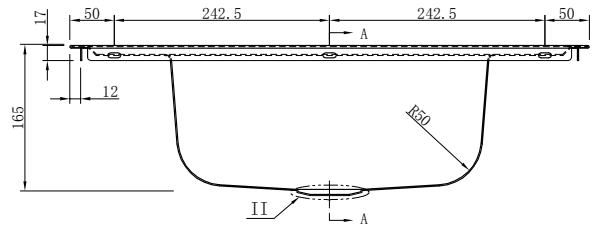
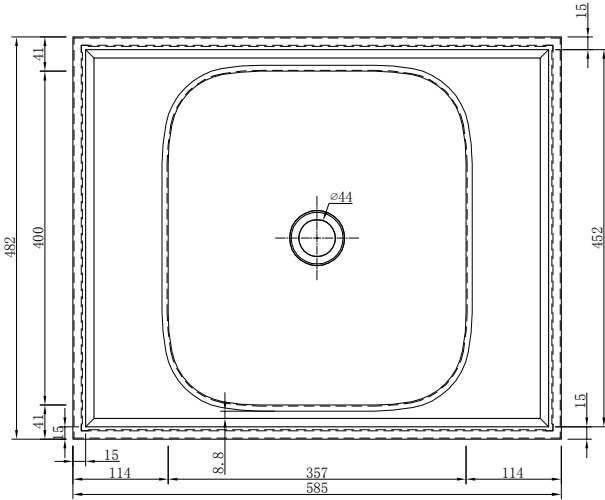

I Detail

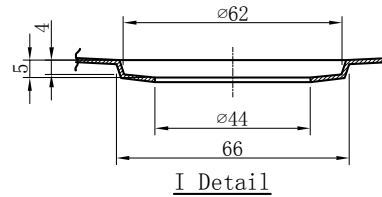

I Detail



When specifying this product please include:

- Product Name and Code
- Product Size / Model

VISIT BRITEXUSA.COM TO DOWNLOAD THE MOST CURRENT PRODUCT LITERATURE.



Due to ongoing research and our commitment to product development, details are subject to change without notice. Details accurate at time of print. Please refer to britex.com.au for the most current product information. Allow +/- 5mm tolerance for dimensions and setouts shown in product literature.

Last Revised: Nov 2023
Revision A