

## features and benefits

- WaterMark certified (ATS 5200.040)
- 25mm flushing perimeter sparge
- Optional stainless P trap waste connection
- Standard or custom sizes available
- Removable bar grate
- Ideal for hospitals, food processing facilities and commercial kitchens

## about

The *BRITEX Flushing Floor Waste* is manufactured from either 1.2mm or 1.6mm grade 304 or 316 stainless steel. WaterMark certified, this unit consists of a flushing hopper which can be fixed to the floor using the perimeter flanges. The unit comes with a 100mm diameter waste dropper which fits easily into PVC pipe work. The flushing ring to the hopper transition allows all internal surfaces to be fully flushed which assists in maintaining high standards of hygiene.

## sample spec. text

*BRITEX S.S. Flushing Floor Waste - Grade 304/316 S.S. 450x450mm, complete with 110mm dia. adjustable stainless steel P Trap and removable grate. WaterMark certified - Product Code US-FFW*

\*RED TEXT may denote a variable where one option only is to be selected, a nominal dimension that needs to be specified, or an optional feature that can be removed if not required. Please refer to the back of this page for additional specification details and options.

VISIT [BRITEXUSA.COM](http://BRITEXUSA.COM) TO DOWNLOAD THE MOST CURRENT PRODUCT LITERATURE.

# FLUSHING FLOOR WASTE

PRODUCT CODE

## US-FFW

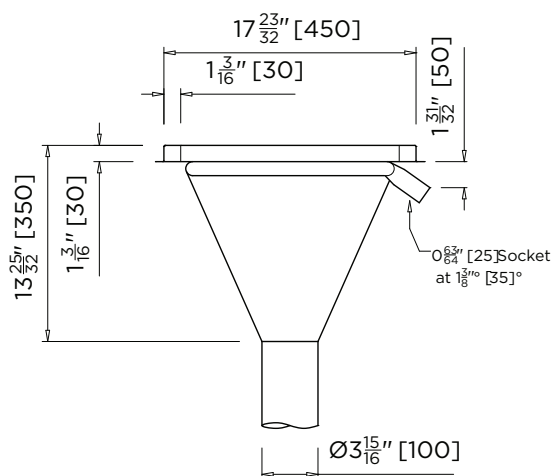

MODEL US-FFW Front Elevation

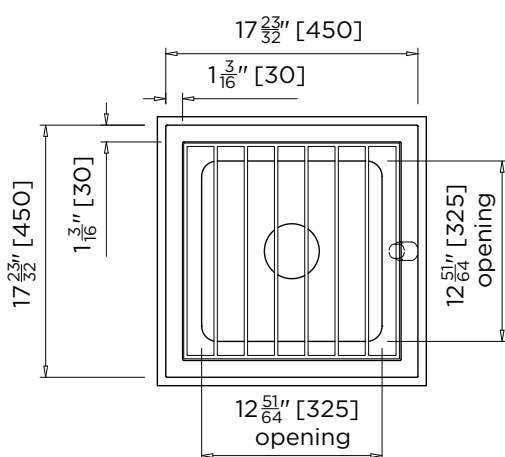

MODEL US-FFW Plan

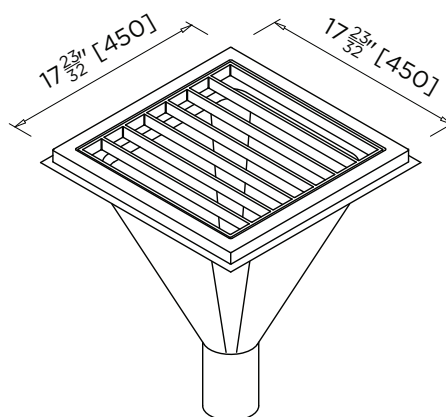

MODEL US-FFW Isometric View

*When specifying this product please include:*

- Product **Name** and **Code**

specifying  
guide

options

- 304 or 316 grade stainless steel
- Custom sizes
- Stainless P trap waste connection

VISIT [BRITEXUSA.COM](http://BRITEXUSA.COM) TO DOWNLOAD THE MOST CURRENT PRODUCT LITERATURE.