

FOOT WASH TROUGH

TROUGHS

#US-TFWS / FOOT WASH TROUGH



features and benefits

- Stainless Steel Construction
- Vandal Resistant and Durable
- Centre Waste Outlet
- Standard or custom sizes available
- Hinged foot grate for ease of cleaning
- Grade 304 SS (1.2mm -16/18 gauge)
- Optional Tapware
- Optional Heavy Duty Stools
- Ideal for prayer rooms, schools, mosques and places of worship

about

The BRITEX Foot Wash Trough is manufactured from 1.2mm grade 304 stainless steel. Vandal resistant and durable this unit consists of a hinged foot grate for ease of cleaning and optional tapware and centre waste outlet. The Britex Foot Wash Trough is available in standard and custom sizes. Heavy Duty stools are available as an optional extra.

sample spec. text

BRITEX S.S. Foot Wash Trough - 23 5/8" [600] x 31 1/2" [800] x 18 5/64" [480] centre waste outlet and hinged foot grate - Product Code US-TFWS

*RED TEXT may denote a **variable** where one option only is to be selected, a **nominal dimension** that needs to be specified, or an **optional feature** that can be removed if not required. Please refer to the back of this page for additional specification details and options.

VISIT BRITEXUSA.COM TO DOWNLOAD THE MOST CURRENT PRODUCT LITERATURE.

FOOT WASH TROUGH

PRODUCT CODE

US-TFWS

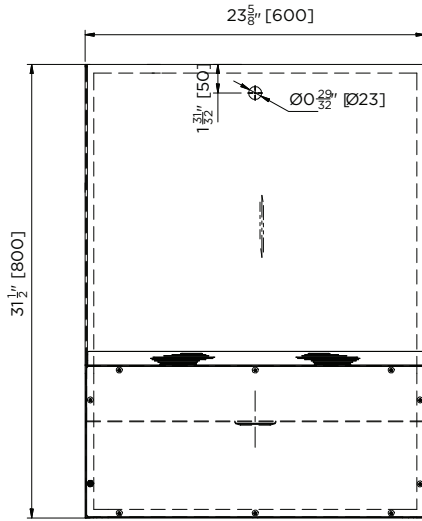

MODEL US-ST2 Front Elevation

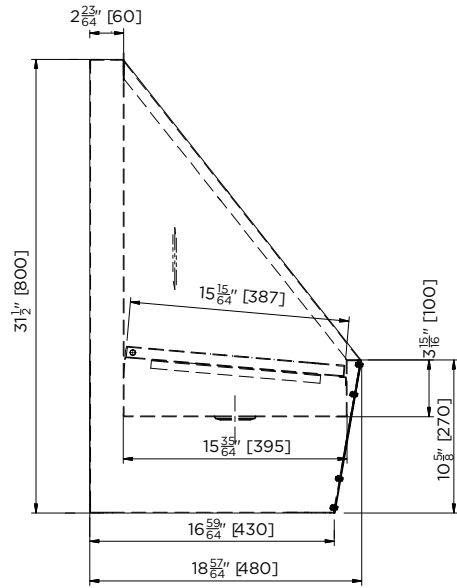

MODEL US-ST2 Section

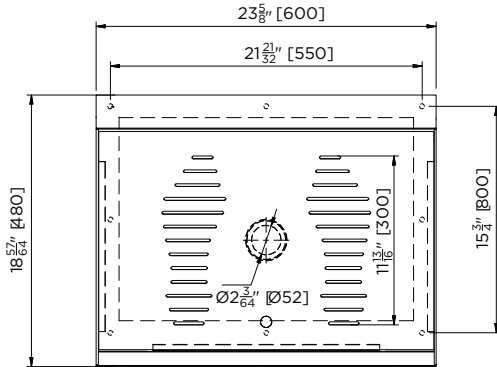

MODEL US-ST2 Plan

specifying
guide

*When specifying this
product please include:*

- Product **Name** and **Code**
- Product **Features**
- Product **Dimensions**

VISIT BRITEXUSA.COM TO DOWNLOAD THE MOST CURRENT PRODUCT LITERATURE.