

GRANDEUR HAND WASH BASIN

6.01

HAND BASINS

#HBGU / GRANDEUR HAND WASH BASIN



Scan QR code
to view online



features and benefits

- Optimal vandal resistance
- Fully welded, seamless construction
- Completely concealed plumbing
- P trap installation
- No sharp edges or corners
- Grade 304 satin S.S.
- Stylish, modern design
- 40mm waste outlet
- Concealed fixings
- Front and rear fixed models
- Choice of tapware styles
- 7 litre bowl capacity
- 1, 2 or 3 tap holes
- Optional anti-ligature waste
- Suits detention projects, holding cells, public amenities and bars

about

The *BRITEX Stainless Steel Grandeur Basin* is a stylish looking fixture that incorporates prison - grade vandal resistance. Key to its design is a fully welded, radiused front edge with rolled safety fascia. A rounded profile above and below the basin also ensures there are no ligature points and all fixing points are concealed. Plumbing connections are secure within the stainless steel shroud that can incorporate an access panel if fixing from the front and an anti-ligature security waste is optional. Can be supplied with anti-vandal timed flow pillar tap, sensor tap or security tapware for maximum vandal resistance.

sample spec. text

*BRITEX S.S. Grandeur Hand Wash Basin - 440L x 400W x 300D O/A. **Front/Rear** fixed model. Complete with rolled safety fascia, 40mm **security/polypropylene** waste outlet and **XXXXX** tapware - Product Code HBGU-XX-TW-XXXX*

NB Please refer to reverse page for tapware and basin options

***RED TEXT** may denote a **variable** where one option only is to be selected, a **nominal dimension** that needs to be specified, or an **optional feature** that can be removed if not required. Please refer to the back of this page for additional specification details and options.

VISIT BRITEX.COM.AU TO DOWNLOAD BIM FILES, CAD DRAWINGS AND THE MOST CURRENT PRODUCT LITERATURE.



MELBOURNE
Britex Place, Mirra Crt
Bundoora VIC 3083
t (03) 9466 9000
f (03) 9466 9011

SYDNEY
16 Northumberland Drv
Taren Point NSW 2229
t (02) 9531 2100
f (02) 9531 2800

PERTH
14 Capital Rd
Malaga WA 6090
t (08) 9249 5464
f (08) 9248 6893

BRISBANE
19 Manila St
East Brisbane QLD 4169
t (07) 3363 2400
f (07) 3363 2444

ADELAIDE
The Britex Group
SA State Office
t 1300 764 744
f 1300 784 306

britex.com.au | info@britex.com.au | A.B.N 83 004 309 737

GRANDEUR HAND WASH BASIN

PRODUCT CODE

HBGU Basin only

HOW TO SPECIFY: Grandeur Hand Wash Basin

Sample Specification Code

A B C
HBGU - RF - TW-9202

= Grandeur Hand Basin, Rear Fixed with Deluxe Timed Flow Mixer Tap

Specification Key

A = Product Code **C = Tapware - if required**
 (see below for suggested tapware options)

B = Fixing Method
RF : Rear Fixed (no access panel)
FF : Front Fixed (left hand access panel)

Suggested Tapware Options:

(see Tapware Section: 11 for complete range of options)



TW-SEC-01
 Security Tap Set
 (Cold Only)



TW-SEC-02
 Security Tap Set
 (Hot & Cold)



TW-9201
 Deluxe Timed Flow
 Pillar Tap



TW-9102
 Eco Timed Flow
 Pillar Tap



TW-9110
 Basin Mounted
 Sensor Tap



TW-MIX-01
 Basin Mounted
 Flick Mixer

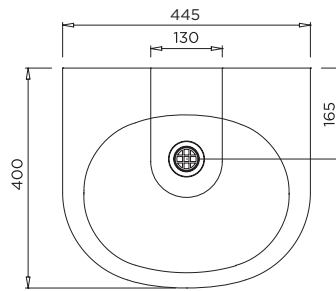

MODEL HBGU Plan

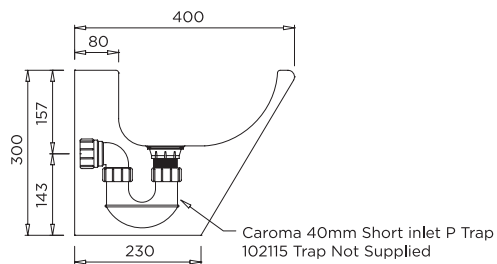

MODEL HBGU Side Elevation

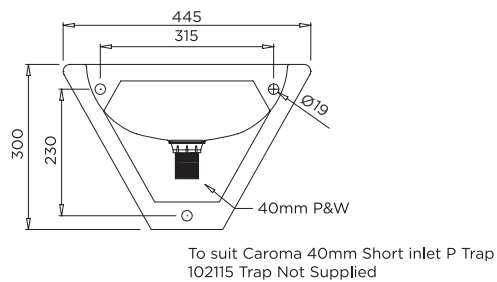

MODEL HBGU Rear Elevation

When specifying this product please include:



- Product **Name** and **Code**
- Product **Dimensions**
- **Tapware** details (if required)
- **Fixing Method** - Front or Rear
- **Waste Type** - Standard or Security



- Tap holes
- Tapware - see Tapware Section: 11
- Anti-ligature security waste - ALWO-40
- Right/left hand access panel

VISIT BRITEX.COM.AU TO DOWNLOAD BIM FILES, CAD DRAWINGS AND THE MOST CURRENT PRODUCT LITERATURE.

Last Revised 2019



Due to ongoing research and our commitment to product development, details are subject to change without notice. Details accurate at time of print. Please refer to britex.com.au for the most current product information. Allow +/- 5mm tolerance for dimensions and setouts shown in product literature.

britex.com.au | info@britex.com.au | A.B.N 83 004 309 737

