

Knee Operated Hand Basin



Scan QR code to view our installation notes



To order this item please advise:

- Spout type: gooseneck or low level
- If optional Tempering Valve required



HBKO

(Low Level Spout option shown)

Product Info:

- User activates spout by leaning against panel
- Complies with food handling standards
- No electrical or power requirements
- Supplied pre-plumbed
- PLV (F1 1/2" fittings) is supplied separately.
- 45° chamfered front corners
- 40mm waste and wall bracket supplied
- Choice of low level or gooseneck spout
- Optional tempering valve

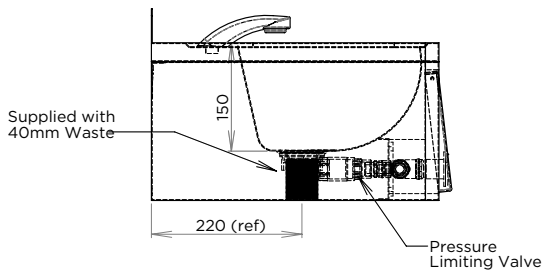

INSTALLATION NOTES

1) Fixture strength is ultimately determined by the load capacity of the supporting structure (noggin recommended for stud walls) and use of appropriate fixings. 2) Basin is secured to wall with an offset bracket positioned behind the splashback and via 8mm fixing holes integrated into tags at the back of the basin body. 3) Minimum flow pressure to 1/2" PLV connection = 200kPa. (Max=350kPa) 4) Tempering valve supplied only by request. 5) Suggested mounting height 850-900mm FFL to basin rim.

