

# BELLAGIO WASH BASIN

6.26

HAND BASINS

#HBBEL / BELLAGIO WASH BASIN



Image shows Model HBBEL-C  
Concave Bowl



Image shows Model HBBEL-A  
Square Edge Bowl



Image shows Model HBBEL-B  
Radius Cornered Bowl

Scan QR code  
to view online



\*Optional tapware shown for indicative purposes only

## features and benefits

- Modern, square profile
- Fully hand made, seamless design
- Grade 304 satin stainless steel
- Double-skinned robust construction
- Choice of internal bowl shapes
- Bench mounted
- 40mm square waste outlet
- 1, 2 or 3 tap holes
- Perfect for clubs, bars and hotels

## about

The *BRITEX Bellagio Wash Basin* is a fully hand made, double-skinned stainless steel counter top wash basin. Manufactured from heavy gauge commercial grade stainless steel, the Bellagio wash basin is supplied complete with a 40mm waste outlet and is both functional and robust. Designed for use in combination with a mixer tap, the Bellagio basin is available in a range of internal bowl shapes and is ideally suited to stylish washrooms in hotels, night clubs and restaurants.

## sample spec. text

*BRITEX Stainless Steel Bellagio Wash Basin - Square Edge/Radius Corner/Concave bowl 450L x 450W x 123D O/A. Double-skinned construction. Supplied in satin finish, complete with 40mm square pop up waste outlet - Product Code HBBEL-X*

\*RED TEXT may denote a **variable** where one option only is to be selected, a **nominal dimension** that needs to be specified, or an **optional feature** that can be removed if not required. Please refer to the back of this page for additional specification details and options.

VISIT [BRITEX.COM.AU](http://BRITEX.COM.AU) TO DOWNLOAD BIM FILES, CAD DRAWINGS AND THE MOST CURRENT PRODUCT LITERATURE.



**MELBOURNE**  
Britex Place, Mirra Crt  
Bundoora VIC 3083  
t (03) 9466 9000  
f (03) 9466 9044

**SYDNEY**  
16 Northumberland Drv  
Taren Point NSW 2229  
t (02) 9531 2100  
f (02) 9531 2800

**PERTH**  
Unit 1/8 Principal Link  
Malaga WA 6090  
t (08) 9249 5464  
f (08) 9248 6893

**BRISBANE**  
19 Manilla St  
East Brisbane QLD 4169  
t (07) 3363 2400  
f (07) 3363 2444

**ADELAIDE**  
The Britex Group  
SA State Office  
t 1300 764 744  
f 1300 784 306

[britex.com.au](http://britex.com.au) | [info@britex.com.au](mailto:info@britex.com.au) | A.B.N 83 004 309 737

# BELLAGIO WASH BASIN

PRODUCT CODE

## HBBEL-A

Square Edge Bowl

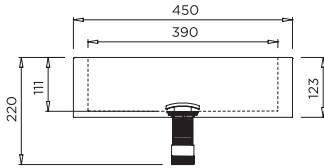

MODEL HBBEL-A Front Elevation

## HBBEL-B

Radius Cornered Bowl

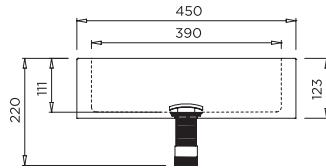

MODEL HBBEL-B Front Elevation

## HBBEL-C

Concave Bowl

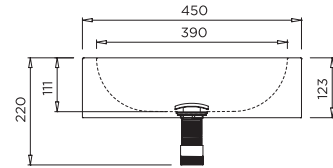

MODEL HBBEL-C Front Elevation

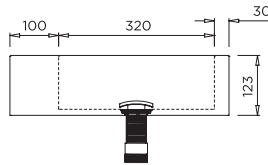

MODEL HBBEL-A Side Elevation

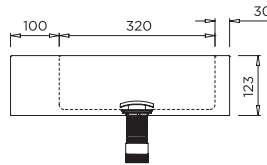

MODEL HBBEL-B Side Elevation

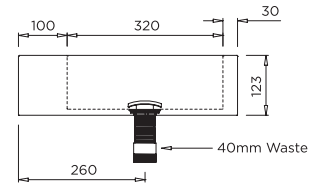

MODEL HBBEL-C Side Elevation

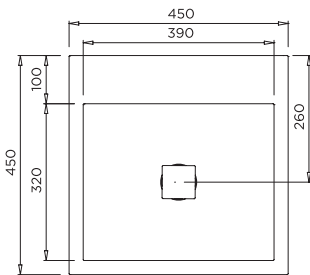

MODEL HBBEL-A Plan

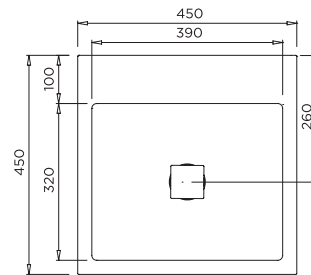

MODEL HBBEL-B Plan

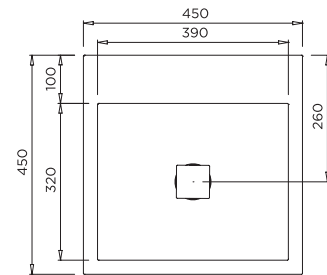

MODEL HBBEL-C Plan

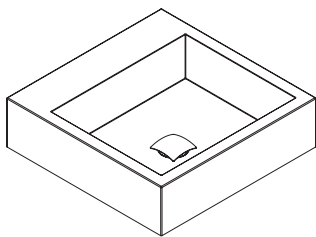

MODEL HBBEL-A Isometric View

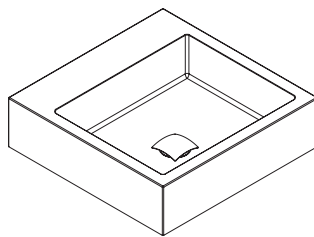

MODEL HBBEL-B Isometric View

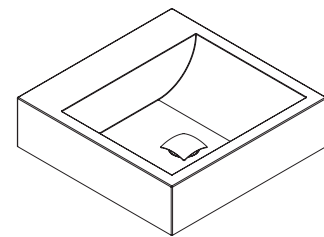

MODEL HBBEL-C Isometric View

*When specifying this product please include:*

- Product **Name** and **Code**
- Product **Dimensions**
- No. of **Tap holes** (if required)
- **Tapware** details (if required)

specifying guide

options

- Semi Recessed Models
- Custom sizes - Consult Britex
- Tapware - see Tapware Section: 11
- Tap holes to suit specified tapware
- Mirror finish bowl
- Round pop up waste

VISIT [BRITEX.COM.AU](http://BRITEX.COM.AU) TO DOWNLOAD BIM FILES, CAD DRAWINGS AND THE MOST CURRENT PRODUCT LITERATURE.

Last Revised June 2017



Due to ongoing research and our commitment to product development, details are subject to change without notice. Details accurate at time of print. Please refer to [britex.com.au](http://britex.com.au) for the most current product information. Allow +/- 5mm tolerance for dimensions and setouts shown in product literature.

[britex.com.au](http://britex.com.au) | [info@britex.com.au](mailto:info@britex.com.au) | A.B.N 83 004 309 737

